

AS-BUILTS FOR: TAMPA ELECTRIC COMPANY BIG BEND ECONOMIZER ASH AND PYRITES POND SYSTEM CLOSURE PHASE II - RESTORATION & GRADING PLANS

APOLLO BEACH, HILLSBOROUGH COUNTY, FLORIDA

ISSUE FOR CONSTRUCTION

WOOD PROJECT NUMBER: 300996x2

March 16, 2022

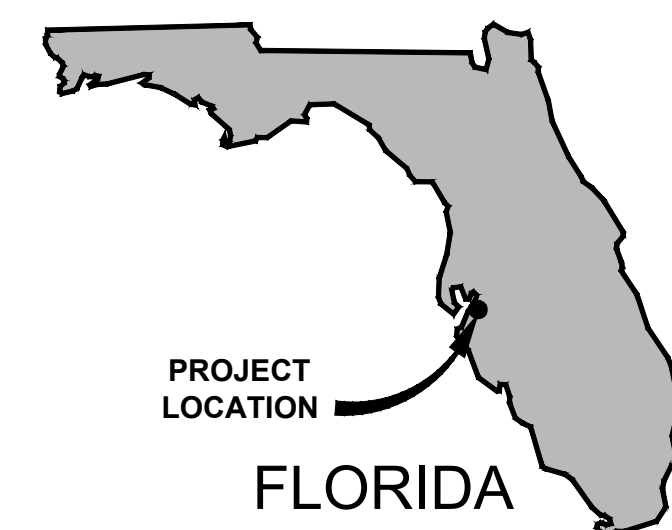
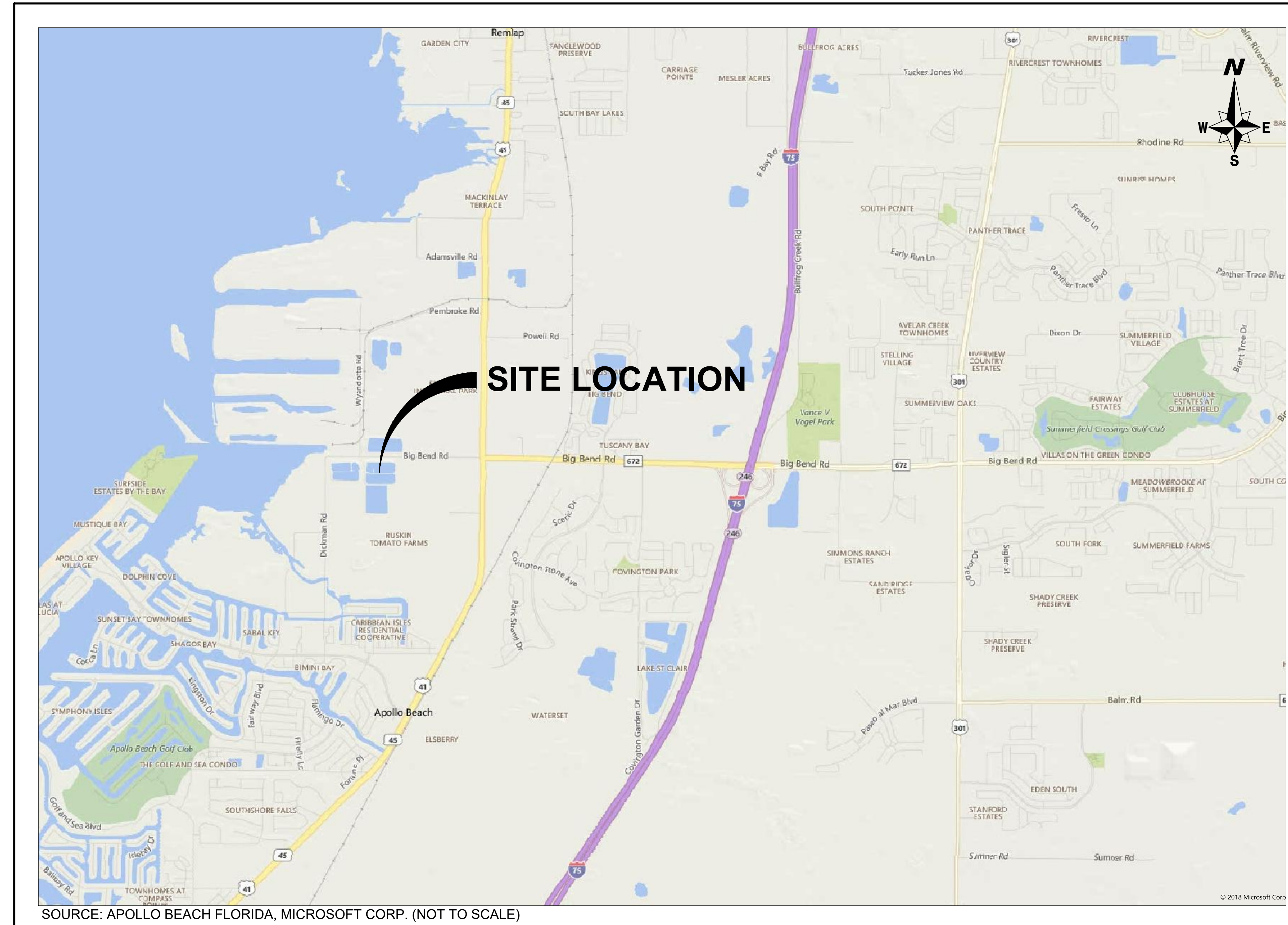

INDEX OF DRAWINGS	
SHEET NUMBER	TITLE
12408-EY-44AT	COVER
12408-EY-44AU	GENERAL NOTES
12408-EY-44AV	POST CLOSURE GRADING PLAN
12408-EY-44AW	BERM RESTORATION PLAN & DETAILS
12408-EY-44AX	ANCHOR DETAIL

ATTENTION IS DIRECTED TO THE FACT THAT THESE PLANS MAY HAVE BEEN REDUCED IN SIZE BY REPRODUCTION. THIS MUST BE CONSIDERED WHEN OBTAINING SCALED DATA.

SITE LOCATION MAP

**HILLSBOROUGH COUNTY, FLORIDA
SECTION 9, TOWNSHIP 31 SOUTH, RANGE 19 EAST**

PLANS PREPARED BY:

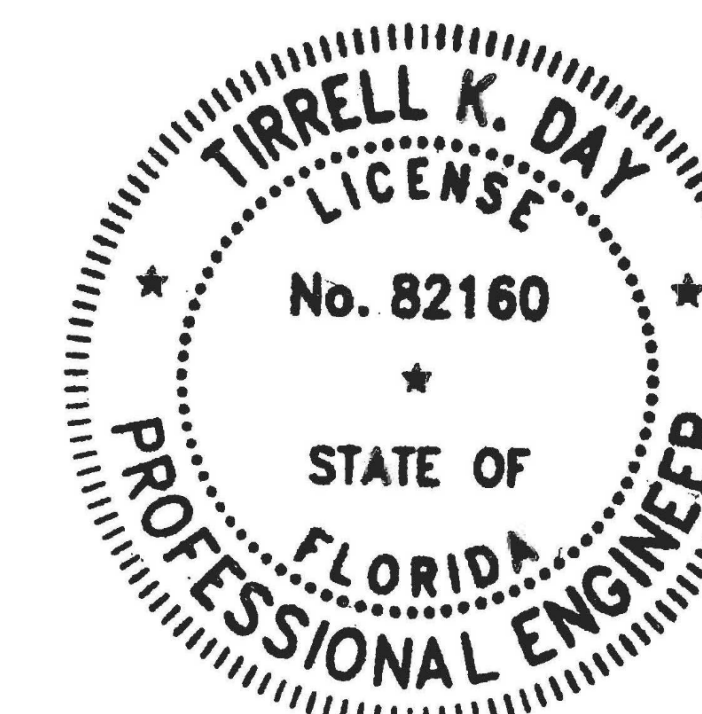

CONTRACTOR IS TO VERIFY EXISTING CONDITIONS PRIOR TO CONSTRUCTION.

NOTE:
CONSTRUCTION PLANS ARE AVAILABLE IN AUTODESK CIVIL 3D FORMAT ONLY. ANY FILE CONVERSIONS WILL BE AT THE CONTRACTOR'S EXPENSE.

ENGINEER CERTIFICATION

I HEREBY CERTIFY THAT I AM A REGISTERED PROFESSIONAL ENGINEER IN THE STATE OF FLORIDA PRACTICING WITH WOOD ENVIRONMENT & INFRASTRUCTURE SOLUTIONS, INC., A CORPORATION AUTHORIZED TO OPERATE AS A BUSINESS PROVIDING ENGINEERING CONSULTING SERVICES. FLORIDA REGISTERED ENGINEERING FIRM F-12, BY THE STATE OF FLORIDA BOARD OF PROFESSIONAL ENGINEERS. I FURTHER CERTIFY THAT I, OR OTHERS UNDER MY DIRECT SUPERVISION, HAVE PREPARED THE GEOTECHNICAL ENGINEERING EVALUATIONS, FINDINGS, CALCULATIONS, CONCLUSIONS OR TECHNICAL ADVICE HEREBY REPRESENTED IN THESE PLANS.

SIGNATURE: _____
NAME: TIRRELL K. DAY, P.E.
P.E. NUMBER: 82160
DATE: _____

12408 - EY - 44AT

PROJECT NUMBER: 300996X2 CITY: TAMPA
 P:\PROJECTS\C3030096X2\TECO Eco Ash Pond System\As-Built\March_2022\300996X2_Restoration Plans_Notes.dwg LAYOUT: 12408-EY-44AU SAVED: 3/16/2022 2:47 PM PLOTTED: 3/16/2022 1:23 PM BY: VIVES, MARTIN

GENERAL

1. ALL CONSTRUCTION SHALL CONFORM TO THE CONSTRUCTION DRAWINGS AND SPECIFICATIONS.
2. THE CONTRACTOR SHALL ACQUIRE THE NECESSARY RIGHT-OF-WAY UTILIZATION PERMIT(S) AND PROVIDE FOR THE SAFETY OF LOCAL TRAFFIC DURING CONSTRUCTION. THE CONTRACTOR SHALL COORDINATE ALL WORK WITHIN EXISTING ROAD RIGHT-OF-WAYS WITH FDOT.
3. THE CONTRACTOR SHALL LOCATE AND VERIFY ALL EXISTING UTILITIES PRIOR TO CONSTRUCTION AND NOTIFY THE VARIOUS UTILITY PROVIDERS TO MAKE THE NECESSARY ARRANGEMENTS FOR ANY RELOCATION, TEMPORARY DISRUPTION OF SERVICE, OR CLARIFICATION OF ACTIVITY REGARDING SAID UTILITY. THE CONTRACTOR SHALL EXERCISE EXTREME CAUTION WHEN CROSSING AN UNDERGROUND UTILITY, WHETHER SHOWN ON THESE PLANS OR FIELD LOCATED. ALL UTILITIES WHICH INTERFERE WITH THE PROPOSED CONSTRUCTION SHALL BE RELOCATED BY THE RESPECTIVE UTILITY PROVIDERS AND THE CONTRACTOR SHALL COOPERATE WITH THE UTILITY PROVIDER DURING RELOCATION OPERATIONS. ANY DELAY OR INCONVENIENCE BY THE VARIOUS UTILITIES SHALL BE INCIDENTAL TO THE CONTRACT AND NO EXTRA COMPENSATION WILL BE ALLOWED.
4. ALL WORK SHALL BE IN ACCORDANCE WITH OWNER'S SAFETY REQUIREMENTS, INCLUDING USE OF EQUIPMENT NEAR/UNDER EXISTING OVERHEAD LINES.
5. THE LOCATION OF ALL EXISTING UTILITIES, STORM DRAINAGE SYSTEMS AND TOPOGRAPHIC FEATURES SHOWN ON THE DRAWINGS ARE PROVIDED FOR THE CONVENIENCE OF THE CONTRACTOR. THE ENGINEER ASSUMES NO RESPONSIBILITY FOR THEIR ACCURACY. SHOULD A DISCREPANCY ARISE BETWEEN THESE DRAWINGS AND ACTUAL FIELD CONDITIONS, WHICH WOULD APPRECIABLY AFFECT THE EXECUTION OF THE WORK, THE CONTRACTOR WILL HALT AFFECTED CONSTRUCTION AND NOTIFY THE OWNER AND ENGINEER IMMEDIATELY.
6. PRIOR TO COMMENCING WORK THE CONTRACTOR SHALL FURNISH, ERECT AND MAINTAIN ALL BARRICADES, WARNING SIGNS, AND MARKINGS FOR HAZARDS AND THE CONTROL OF TRAFFIC, IN REASONABLE CONFORMITY WITH THE MANUAL OF UNIFORM TRAFFIC CONTROL DEVICES FOR STREET AND HIGHWAYS OR AS DIRECTED BY THE OWNER, SUCH AS TO EFFECTIVELY PREVENT ACCIDENTS IN ALL PLACES WHERE THE WORK CAUSES OBSTRUCTIONS TO THE NORMAL TRAFFIC OR CONSTITUTES IN ANY WAY A HAZARD TO THE PUBLIC OR OWNER'S OPERATIONS.
7. ALL WORK AND MATERIALS FURNISHED SHALL CONFORM WITH THE LINES, GRADES, GRADING SECTIONS, CROSS SECTIONS, DIMENSIONS, MATERIAL REQUIREMENTS, AND TESTING REQUIREMENTS THAT ARE SPECIFIED IN THE CONTRACT, PLANS OR SPECIFICATIONS.
8. THE CONTRACTOR IS TO FURNISH, ERECT, AND MAINTAIN ALL BARRICADES, WARNING SIGNS, AND MARKINGS FOR HAZARDS NECESSARY TO PROTECT THE PUBLIC, OWNER'S OPERATIONS, AND THE WORK.

SURVEY NOTES

1. ELEVATIONS ARE SHOWN IN TEC PLANT DATUM. TO CONVERT TO NAVD88, SUBTRACT 1.971 FT FROM THE PLANT DATUM. TO CONVERT PLANT DATUM TO NAVD29, SUBTRACT 1.072 FT FROM PLANT DATUM.
2. CONCEPTUAL MAP, ELEVATIONS AND FEATURE LOCATIONS ARE BASED ON SURVEY BY GEORGE F. YOUNG INC. DATED NOVEMBER 8, 2018.
3. CONTRACTOR TO COORDINATE WITH THE OWNER TO VERIFY EXISTING SURVEY MONUMENTS.
4. EXISTING CONDITIONS AT START OF PHASE II WILL REPRESENT CONDITIONS AFTER ALL ASH HAS BEEN REMOVED FROM NEAP AND SEAP, AND ALL LINER AND DEMOLITION HAS OCCURRED WITHIN THE EAPPS WITH THE EXCEPTION OF THE NORTH BERM OF THE LTFAP. DEMOLITION OF STRUCTURES AND LINER REMOVAL FROM THE NORTH BERM OF THE LTFAP WILL BE COMPLETED DURING PHASE II.
5. FOR EXISTING CONDITIONS, GEORGE F. YOUNG SURVEY DATED 11/8/18 WAS USED AS A BASE. THE INTERIORS OF THE PONDS WERE APPROXIMATED BY EXTENDING THE INTERIOR SURVEYED SLOPES DOWN AT A SLOPE OF 2.6:1 TO THE ELEVATIONS SHOWN IN STONE & WEBSTER ENGINEERING CORPORATION DRAWING NUMBER 12408-EP-66R-5 LAST REVISED 1/10/84.

AS-BUILT CONDITIONS AND DESIGN MODIFICATIONS ARE NOTED IN RED



DATE: March 16, 2022
 DRAWN BY: M.VIVES
 CHECKED BY: T.DAY
 PROJECT NO.: 300996X2

12408 - EY - 44AU

TAMPA ELECTRIC CO.
 BIG BEND POWER STATION
 ECONOMIZER ASH POND CLOSURE
 GENERAL NOTES
 APOLLO BEACH, FLORIDA



NO.	DATE	REVISION
2	03/19/22	UPDATED TO CORRECT DRAWING NUMBERS
1	11/02/21	AS-BUILT
0	3/22/19	ISSUED FOR CONSTRUCTION

COORDINATE WITH TECO BEFORE COMMENCING CONSTRUCTION ACTIVITIES
UNDER/ WITHIN 25' HORIZONTALLY FROM ANY OVERHEAD POWER LINES

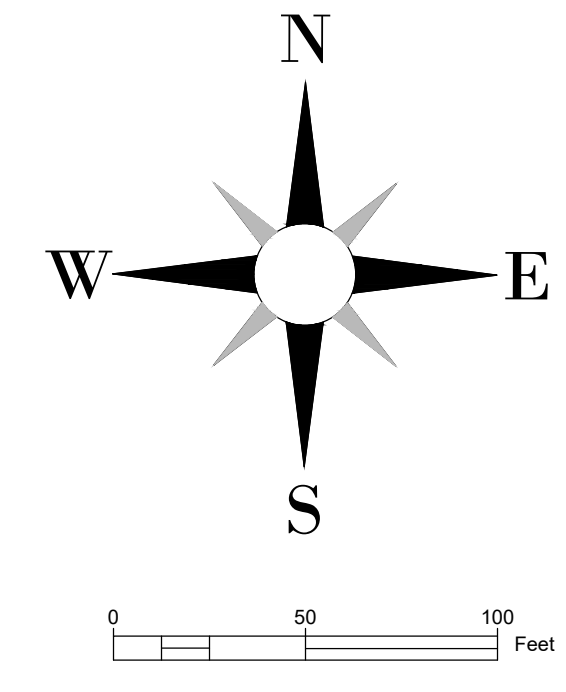

Big Bend Road

Big Bend Road

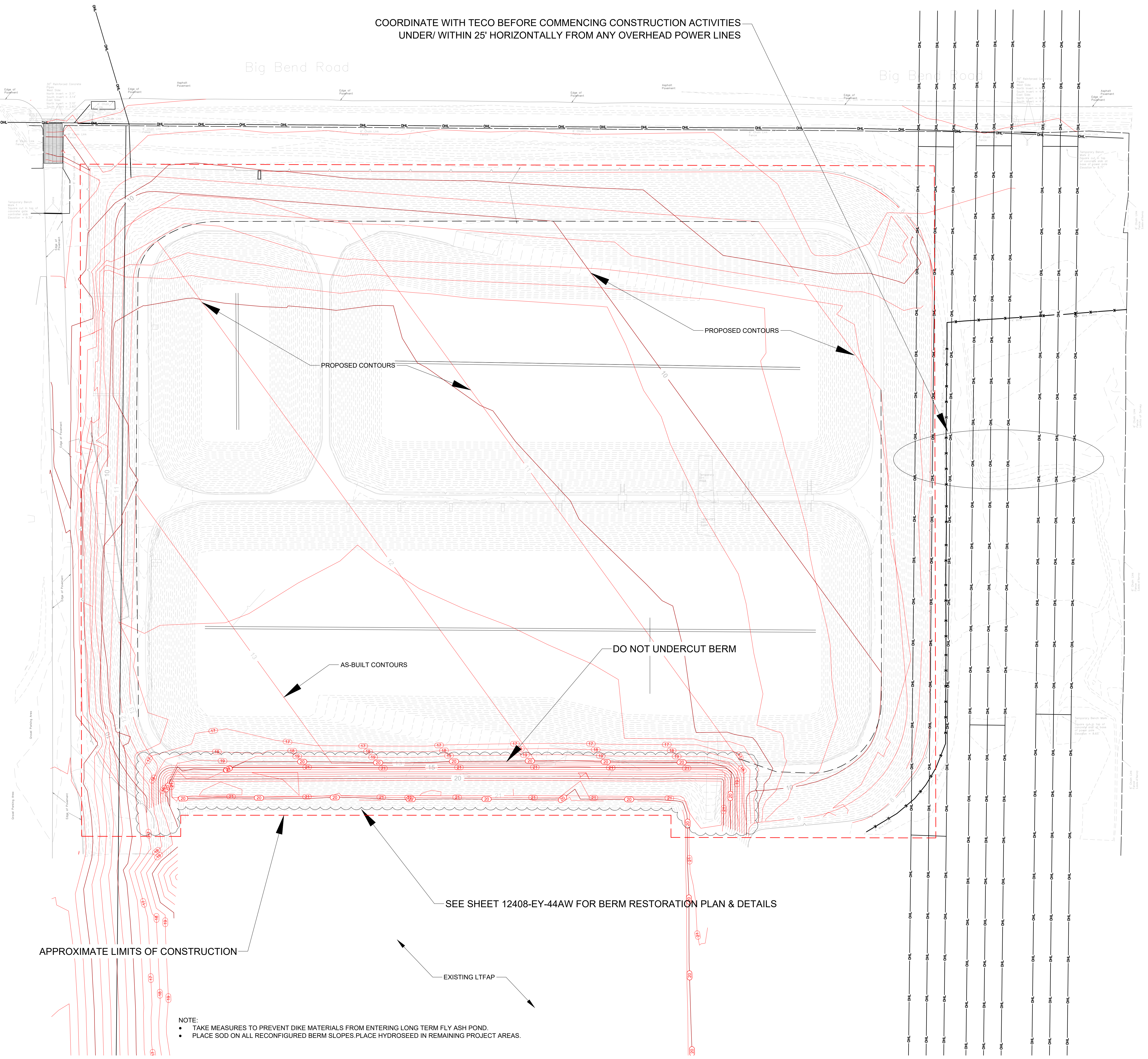

PROPOSED CONTOURS

PROPOSED CONTOURS

AS-BUILT CONTOURS

DO NOT UNDERCUT BERM

SEE SHEET 12408-EY-44AW FOR BERM RESTORATION PLAN & DETAILS

APPROXIMATE LIMITS OF CONSTRUCTION

EXISTING LTFAP

- NOTE:
- TAKE MEASURES TO PREVENT DIKE MATERIALS FROM ENTERING LONG TERM FLY ASH POND.
 - PLACE SOD ON ALL RECONFIGURED BERM SLOPES. PLACE HYDROSEED IN REMAINING PROJECT AREAS.

NO.	DATE	REVISION
2	03/18/22	UPDATED TO CORRECT DRAWING NUMBERS
1	11/02/21	AS-BUILT
0	3/22/19	ISSUED FOR CONSTRUCTION

wood.
Environmental & Infrastructure Solutions, Inc.
1101 Orange Avenue, Suite 1000
Tampa, FL 33602
Phone: 813.288.0000
www.woodgroup.com

TAMPA ELECTRIC CO.
BIG BEND POWER STATION
ECONOMIZER ASH POND CLOSURE
POST CLOSURE GRADING PLAN
APOLLO BEACH, FLORIDA



DATE: March 18, 2022
DRAWN BY: M.VIVES
CHECKED BY: T.DAY
PROJECT NO.: 300996X2

PROJECT NUMBER: 300996X2 CITY: TAMPA
 P:\PROJECTS\CAD\300996X2\TECO Eco Ash Pond System\As-Built\March_2022\300996X2_ Restoration Plans_ Prop. FG TECO.dwg LAYOUT: 12408-EY-44AW SAVED: 3/18/2022 11:15 AM PLOTSTYLETABLE: CIVIL-MASTER.CTB PLOTTED: 3/18/2022 1:28 PM DRAWN BY: VIVES, MARTIN

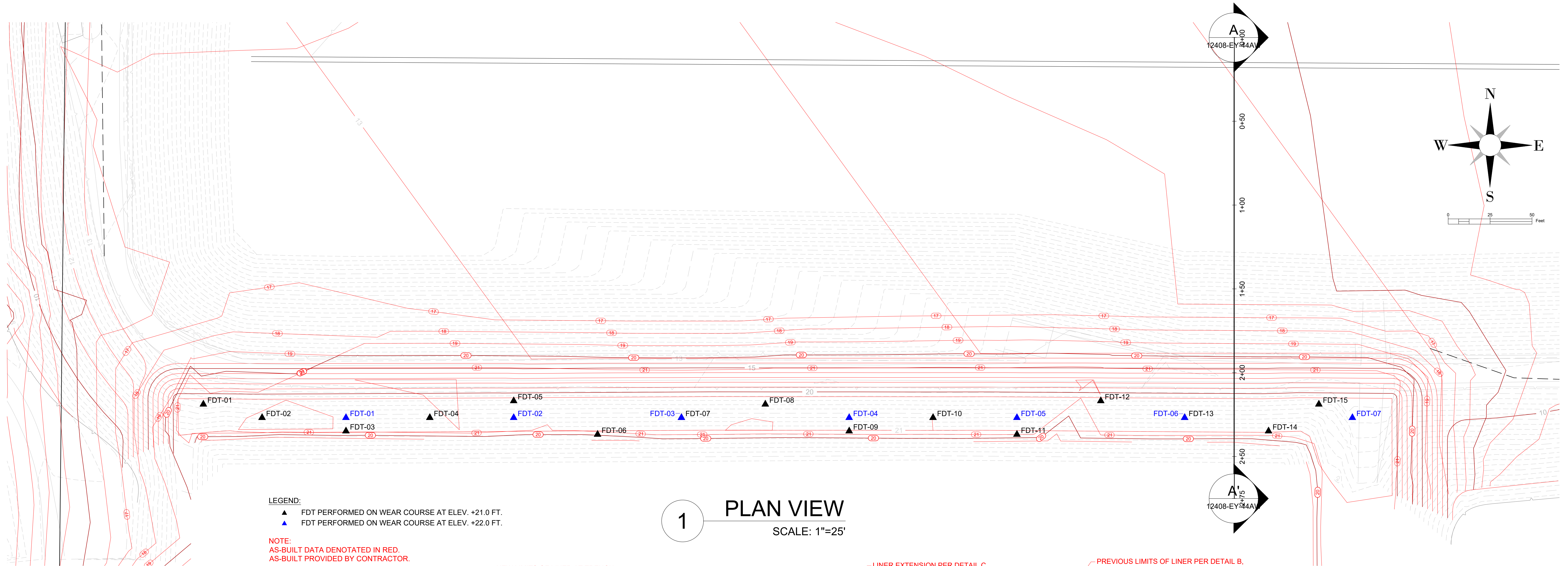

LEGEND:
 ▲ FDT PERFORMED ON WEAR COURSE AT ELEV. +21.0 FT.
 ▲ FDT PERFORMED ON WEAR COURSE AT ELEV. +22.0 FT.

NOTE:
 AS-BUILT DATA DENOTATED IN RED.
 AS-BUILT PROVIDED BY CONTRACTOR.

1 PLAN VIEW
 SCALE: 1"=25'

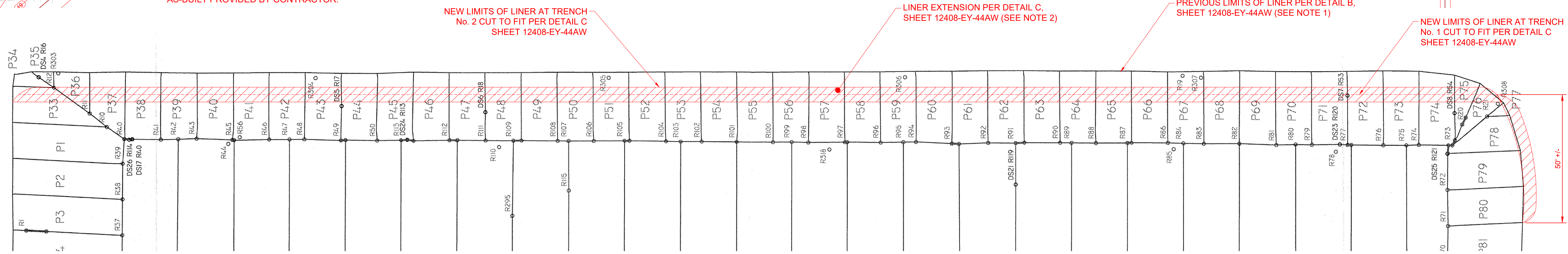

2 EXISTING LINER PLAN FOR NORTH BERM OF LTFAP
 NOT TO SCALE

NOTES:
 1. LINER PLAN IS BASED ON COMANCO "LONG TERM FLY ASH POND REPLACEMENT" DATED 3/7/2012.
 2. LINER EXTENSION PER DRAWING R-01 AS PART OF THE TECO BIG BEND ECONOMIZER POND CLOSEOUT SUBMITTAL FROM CHESAPEAKE CONTAINMENT SYSTEMS, INC. DATED JUNE 16, 2021.

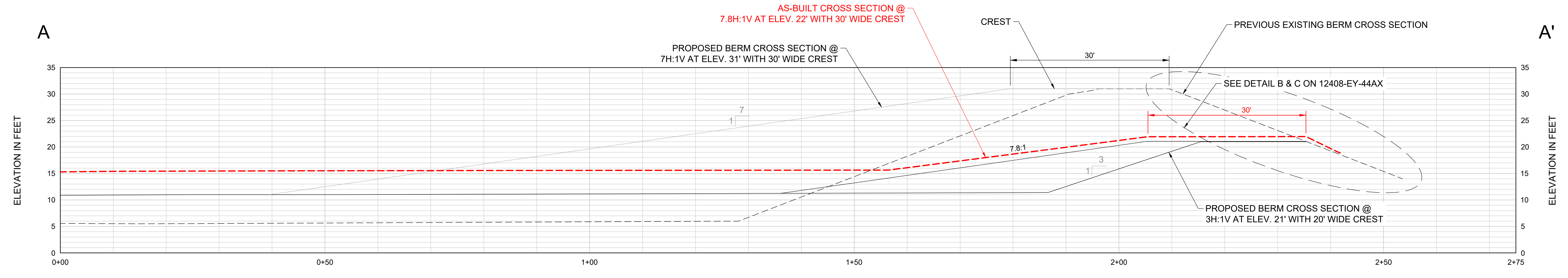

A CROSS SECTION A-A'
 SCALE: AS SHOWN

NOTE:
 AS-BUILT DATA DENOTATED IN RED.
 AS-BUILT PROVIDED BY CONTRACTOR.

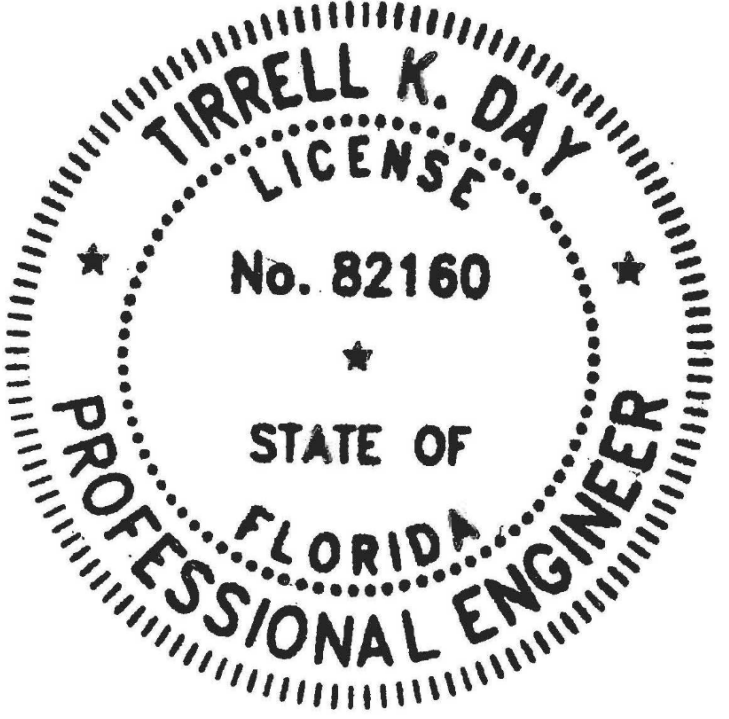

		2	03/18/22	UPDATED TO CORRECT DRAWING NUMBERS
		1	11/02/21	AS-BUILT
		0	3/22/19	ISSUED FOR CONSTRUCTION
NO.	DATE	REVISION		
TAMPA ELECTRIC CO. BIG BEND POWER STATION ECONOMIZER ASH POND CLOSURE BERM RESTORATION PLAN & DETAILS APOLLO BEACH, FLORIDA				
DATE: March 18, 2022		DRAWN BY: M. VIVES		
CHECKED BY: T. DAY		PROJECT NO.: 300996X2		
12408-EY-44AW				

PROJECT NUMBER: 300996X2 CITY: TAMPA
 P:\PROJECTS\CAD\300996X2\TECO Eco Ash Pond System\As-Built\March_2022\300996X2_ Restoration Plans_ Details.dwg LAYOUT: 12408-EY-44AX SAVED: 3/16/2022 2:48 PM PLOTSTYLETABLE: CIVIL-MASTER.CTB PLOTTED: 3/18/2022 1:28 PM DRAWN BY: VIVES, MARTIN

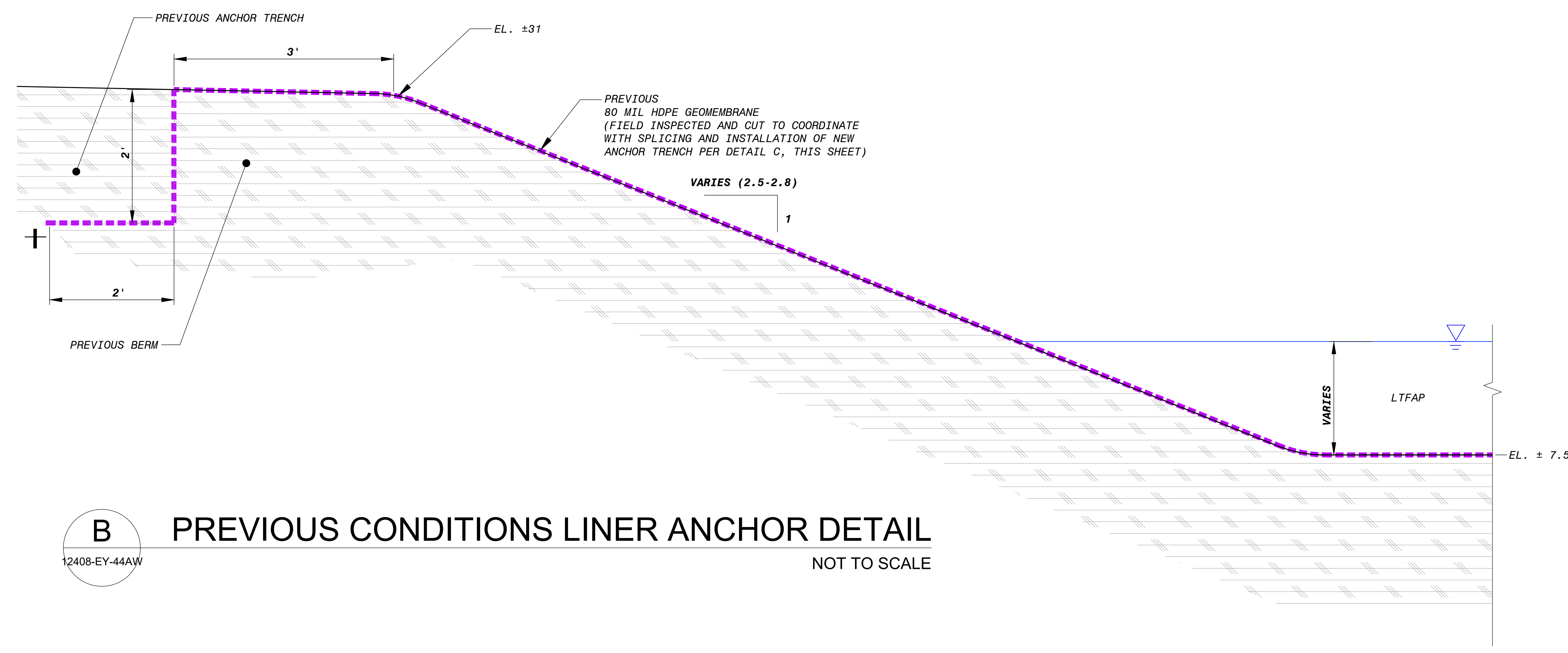

B PREVIOUS CONDITIONS LINER ANCHOR DETAIL
 12408-EY-44AW NOT TO SCALE

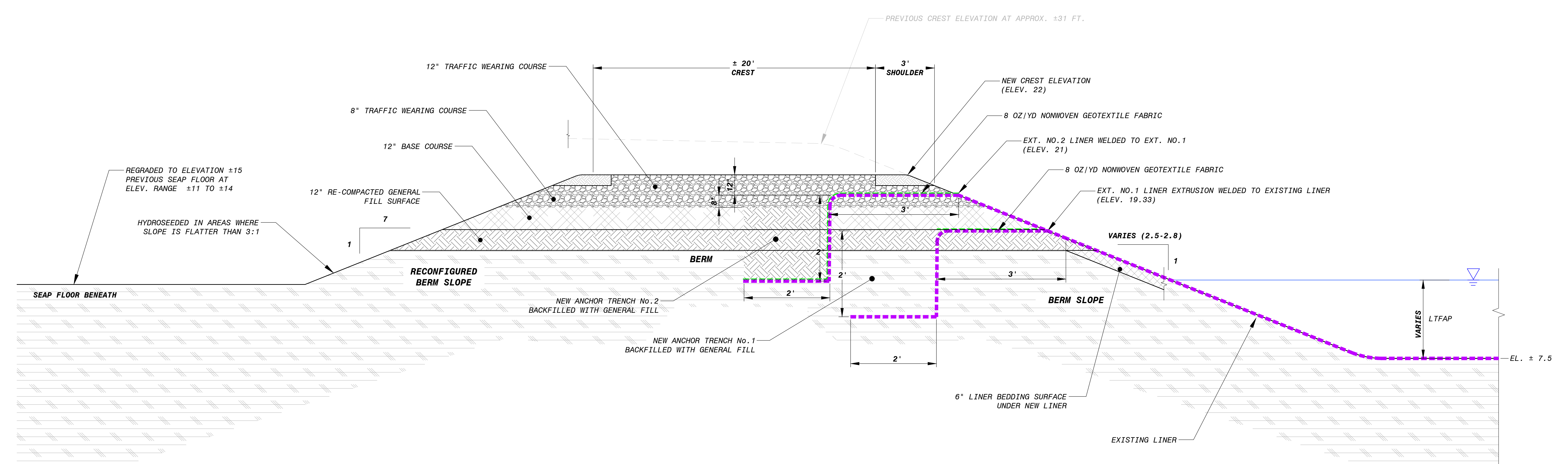

C RECONFIGURED BERM DETAIL
 12408-EY-44AW NOT TO SCALE

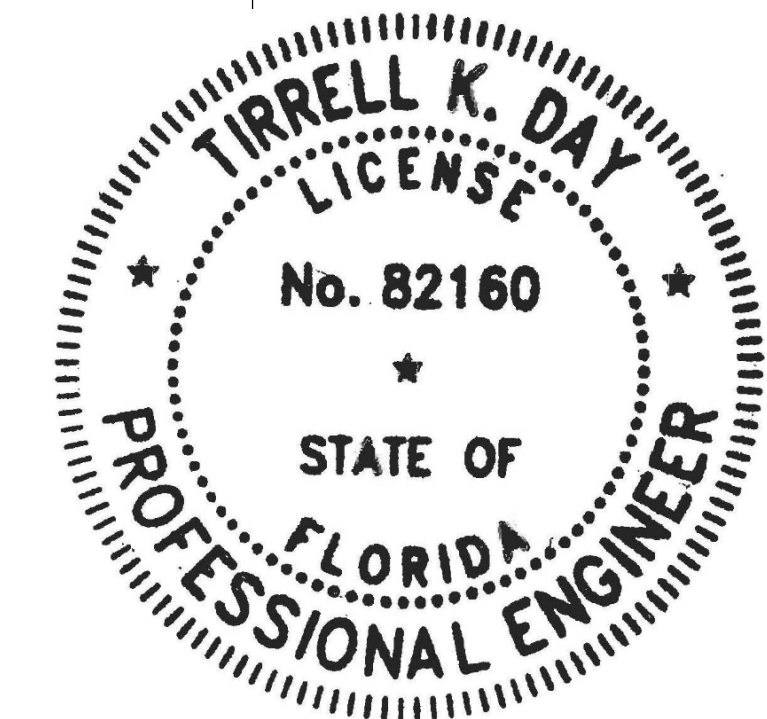

<p>wood. Environment & Infrastructure Solutions, Inc. 1510 Chumley Drive, Suite 200, Tampa, FL 33622 Phone: 813.289.1000 Fax: 813.289.1044 www.woodgroup.com</p>													
<p>TAMPA ELECTRIC CO. BIG BEND POWER STATION ECONOMIZER ASH POND CLOSURE ANCHOR DETAIL APOLLO BEACH, FLORIDA</p>	<p>DATE: March 16, 2022 DRAWN BY: M. VIVES CHECKED BY: M. KELLEY PROJECT NO.: 300996X2</p>												
<table border="1"> <thead> <tr> <th>NO.</th> <th>DATE</th> <th>REVISION</th> </tr> </thead> <tbody> <tr> <td>2</td> <td>03/18/22</td> <td>UPDATED TO CORRECT DRAWING NUMBERS</td> </tr> <tr> <td>1</td> <td>11/02/21</td> <td>AS-BUILT</td> </tr> <tr> <td>0</td> <td>3/22/19</td> <td>ISSUED FOR CONSTRUCTION</td> </tr> </tbody> </table>	NO.	DATE	REVISION	2	03/18/22	UPDATED TO CORRECT DRAWING NUMBERS	1	11/02/21	AS-BUILT	0	3/22/19	ISSUED FOR CONSTRUCTION	<p>12408-EY-44AX</p>
NO.	DATE	REVISION											
2	03/18/22	UPDATED TO CORRECT DRAWING NUMBERS											
1	11/02/21	AS-BUILT											
0	3/22/19	ISSUED FOR CONSTRUCTION											